

Quick Guide for DAQ-BT

1. Connect the USB power cable to the power adapter and to the socket on the back side of the DAQ-BT device. Then connect the power adapter to a wall outlet to power the DAQ-BT.



2. Push and hold the power button on the front for at least 5 seconds until **both** LEDs flash with a green light. Now the Windows PC pairing mode is enabled.



3. To pair the DAQ-BT device in Windows click:

Start→*Settings*→*Devices*→*Add device*→*Bluetooth device*

, wait for the list of devices and select

BTH-1208LS-XXXX. The pairing code is 0000.

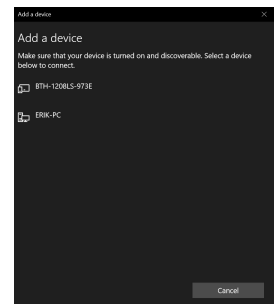

4. To turn the DAQ-BT device ON or OFF (with pairing mode disabled), push and hold the power button for 3 seconds.
5. Connect a Loligo® swim tunnel controller to the DAQ-BT device using the data cables on the backside of the instrument.

